

AERODROME GROUND
MOVEMENT CHART - ICAO

APRON ELEV 6 m

TWR	118.8	118.2
GND	121.7	121.75
APRON	121.65	122.175
	121.8	121.875

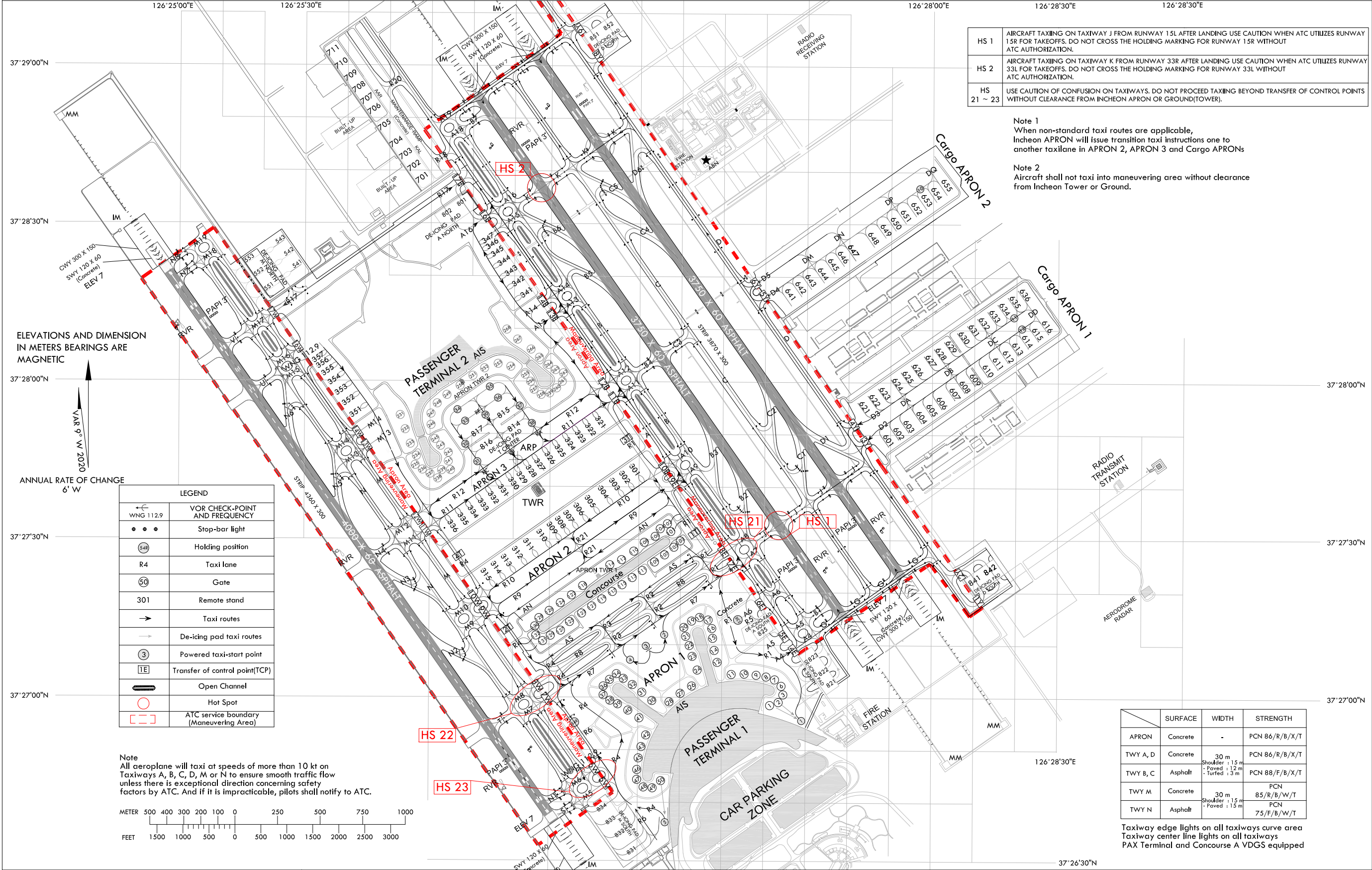

Change : Establishment of lead in · out line, Stop bar light(TWY M) and Information of Stop bar light(TWY R17), HS.

OFFICE OF CIVIL AVIATION

AIRAC AIP AMDT 11/20
Effective : 1600UTC 2 DEC 2020

AERODROME GROUND
MOVEMENT CHART - ICAO

APRON ELEV 6 m

TWR	118.8	118.2
GND	121.7	121.75
APRON	121.65	122.175 121.8 121.875

SEOUL / Incheon Intl
RWY 15L/R, 33L/R ARRIVAL

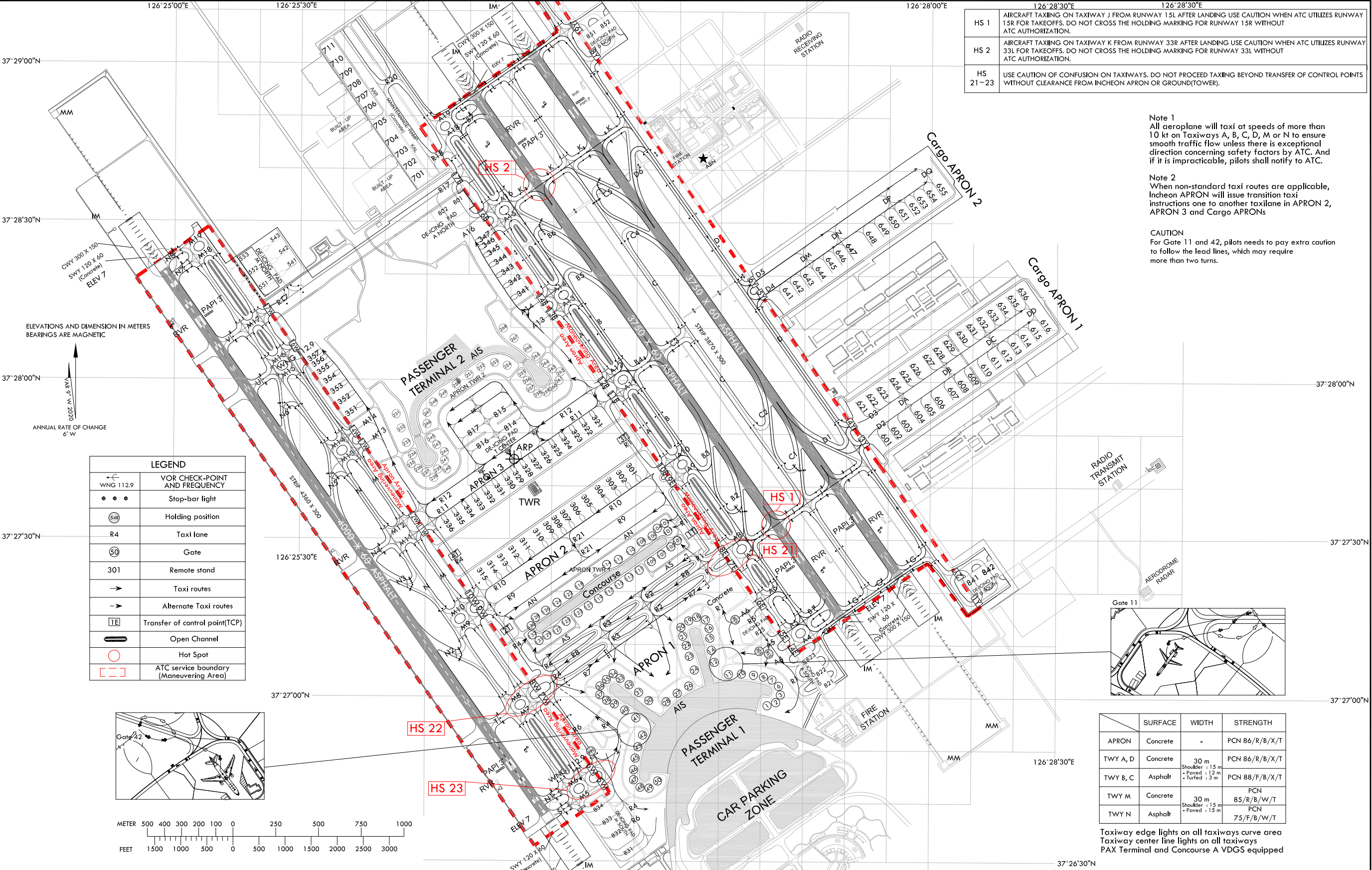

Change : Establishment of lead in · out line, Stop bar light(TWY M) and Information of Stop bar light(TWY R17), HS.

OFFICE OF CIVIL AVIATION

AIRAC AIP AMDT 11/20
Effective : 1600UTC 2 DEC 2020

AERODROME GROUND
MOVEMENT CHART - ICAO

APRON ELEV 6 m

TWR	118.8	118.2
GND	121.7	121.75
APRON	121.65	122.175 121.8 121.875

SEOUL / Incheon Intl
RWY 16, 34 DEPARTURE

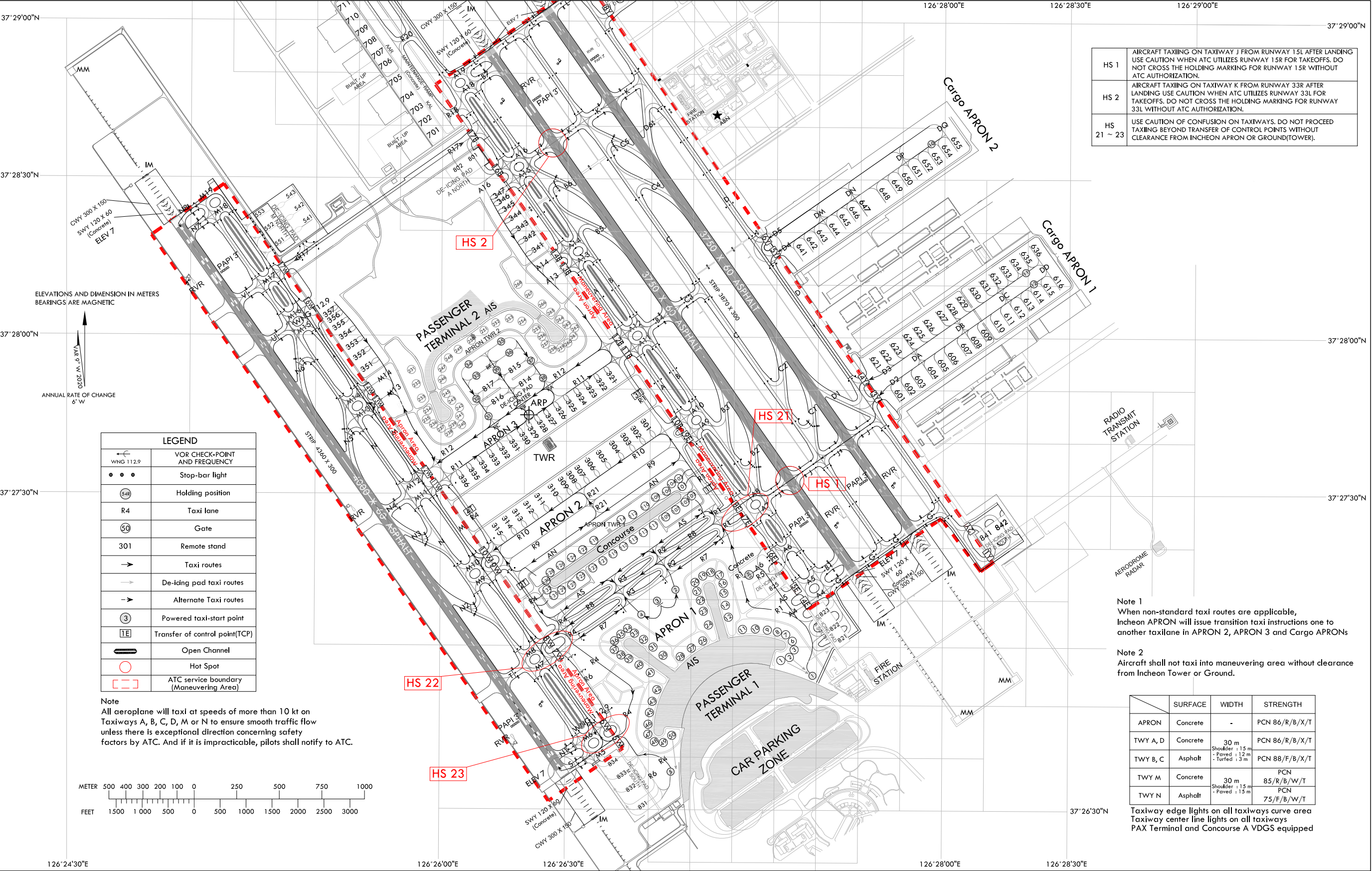

Change : Establishment of lead in · out line, Stop bar light(TWY M) and Information of Stop bar light(TWY R17), HS.

OFFICE OF CIVIL AVIATION

AIRAC AIP AMDT 11/20
Effective : 1600UTC 2 DEC 2020

AERODROME GROUND
MOVEMENT CHART - ICAO

APRON ELEV 6 m

TWR	118.8	118.2
GND	121.7	121.75
APRON	121.65	122.175 121.8 121.875

SEOUL / Incheon Intl
RWY 16, 34 ARRIVAL

